

## Grow the Business: Thanks for the leads!

Bob Briggs

TJ Thieken

John MacGregor

Every associate who reports a new business lead is entered into a drawing for \$100 in **GEM** and **RLI** merchandise. The next drawing is in July for leads generated in April, May and June.

**Report your leads to:**

**Shannon Deppen**, RLI, ext. 3005  
Shannon.Deppen@RLGbuilds.com

**Julie Camper**, GEM, ext. 2654  
Julie.Camper@rlgbuilds.com



# GREAT WORK REQUIRES GREAT PEOPLE

Thank you for providing a candidate referral in the month of **April!**

**Andy Mack**

**Brynn Conine**

**Erin Stoner**

**Bill Cornett**

**Chris Burton**

**Feras Nahouli**

**Brad Mitchell**

**David DeVore**

**Jason Sekulski**

**Brandon Heidecker**

**Julie Camper**

These associates have been entered into a quarterly drawing for a \$100 Amazon gift card!

**Know someone who would be a great addition to RLG?  
Contact Sara Caris at [Sara.Caris@rlgbuilds.com](mailto:Sara.Caris@rlgbuilds.com)**

## Associate Education: Business of the Business sessions

The Business of the Business program educates our associates on the multi-disciplines of RLG and our competitive advantage in the marketplace.

Sessions include:

- Department presentations.
- RLG trivia (with gift cards up for grabs!) over the lunch hour (lunch provided).
- VDC technology demonstrations.
- Campus tours.

Next sessions: **June 5** (GEM) and **June 18** (RLI).  
Contact **Sara Caris** in HR to register.



## GEM: New service contracts

Buff City Soap

Toledo



# NOW HIRING

WALBRIDGE



**Business Development Manager**

**Administrative Assistant**

**IT Network Engineer**

**Proposal Coordinator**

**Project Engineer**

ONE GROUP  
OF COMPANIES,  
UNLIMITED  
**CAREER**  
OPPORTUNITIES

[RLGbuilds.com/Careers](https://www.rlgbuilds.com/Careers)



## RLGU: Mobile app download instructions

Here's how to access RLGU's mobile app:

- Open your App Store (App Store or Google Play).
- Type in "Go Learn" and download the app.



- Open the App and type in <https://rlgbuilds.docebosaaS.com> then select "Proceed to Login Page."
- Sign in with Okta.
- All of your trainings are now available on your device.



## Interdependability: Honda/Harris



Jeffersonville, Ohio – Success builds success – and it happens best when we commit to the success of others.

**Commit to the success of others –  
the Building Success Together  
Roadmap**

GEM was originally hired by national contractor Harris for a \$14.5 million piping job at the under-construction Honda plant in southwestern Ohio.

*Interdependability:  
Making the choice to work together  
and be the person others can count  
on to accomplish something even  
greater than what could be  
achieved working independently.*

They added a \$10 million sheet metal job, a \$5 million contract to set equipment, and got GEM Service involved with preventive maintenance for HVAC equipment.

Mechanical Project Engineer **Andrew Moses** says the GEM team is always on the lookout for other work.



*(Continued on next slide)*

## Interdependability: Honda/Harris

To get the work properly estimated and planned takes a great deal of coordination among various GEM divisions.

Moses says making sure a lot of smart people are in the same room helps make sure the numbers work and there are enough workers available to complete the job.

There was also a great deal of coordination needed to ensure enough fabrication capability existed.

Three fab shops – Walbridge, Lima and Northeast Ohio – are providing materials for this project while serving other clients.



**Commit to the success of others –  
the Building Success Together  
Roadmap**

*Interdependability:  
Making the choice to work together  
and be the person others can count  
on to accomplish something even  
greater than what could be  
achieved working independently.*





## Welcome: New associates



**Lauren Lewis**  
Project Controls  
Accounting  
RLI Walbridge



# MIND MATTERS

Breaking Stigma & Nurturing Wellbeing

Join our lunch and learn webinar series!



Thank you to all who joined our first Mind Matters Lunch and Learn on Neurodiversity in the Workplace.



Join us Tuesday, May 21st for the next session on Meditation for Self-Awareness and Self-Regulation with Rachel Wixey.

REGISTER NOW



Neuro-osity

diverse brains | wonderful minds

# NOW HIRING



PLYMOUTH

**Preconstruction Services**

**Project Engineer**

ONE GROUP  
OF COMPANIES,  
UNLIMITED  
**CAREER**  
OPPORTUNITIES

[RLGbuilds.com/Careers](https://www.rlgbuilds.com/Careers)

# 45 Years With RLI: Congratulations Ken Youster!



**Ken Youster**  
Superintendent  
Field Operations  
RLI Walbridge  
45 years!

# RLG & UNITED WAY

## MAKING OUR COMMUNITY BETTER

More than ever, our community needs our support. The United Way is our partner in helping better the community in so many ways.

*Please join us on **May 9**, at your retrospective headquarters for breakfast and a brief presentation on how you can make a difference.*

Join your fellow RLG employees in supporting our local community.



**Promotion:** Congratulations Brandon Boehm!



**Brandon Boehm**  
Preconstruction Leader  
RLI Walbridge

# NOW HIRING



WALBRIDGE

**Senior Estimating Leader**

**Senior Safety Specialist**

**Solar Project Engineer**

**Solar Project Manager**

ONE GROUP  
OF COMPANIES,  
UNLIMITED  
**CAREER**  
OPPORTUNITIES

[RLGbuilds.com/Careers](https://www.rlgbuilds.com/Careers)

## Give Blood: GEM drive set for May 2

There is still time to register for GEM's blood drive, which will be held May 2 from 9 a.m. to 2 p.m. in Conference Room E.

Due to the demand for blood, The American Red Cross is offering the following incentives:

- A coupon for a free haircut at Sports Clips.
- \$10 e-gift card.
- A chance to win a trip for two and VIP experience to the 2024 NASCAR Cup Series and Xfinity Races at Darlington Raceway on Labor Day weekend.

Register by calling 1-800-RED CROSS, go online at [RedCrossBlood.org](https://RedCrossBlood.org) (sponsor code: GEM), or scan the QR code on the flyers posted in both Walbridge buildings.



**American  
Red Cross**



## New Work: First Solar



**Perrysburg Township, Ohio** – GEM will set equipment to treat wastewater, ultra-pure water (UPW) and chemical systems at First Solar’s PGT-04 facility.

GEM will receive, set and anchor owner-supplied tanks, pump skids, filter press, reverse-osmosis skids, filter skids and boilers for the project.

It will also install all mechanical and electrical to the wastewater UPW and chemical equipment and panels in the plant’s Wastewater Treatment room.

The project is expected to wrap up at the end of the month.

The team: Mechanical Project Manager **Jason Cobb**; Electrical Project Manager **Adam Fackler**; Piping Foreman **Jared Dusseau**; Electrical Foreman **Steve Decant**; Millwright Foreman **Jeff Thorn**.



**SCAN HERE  
TO PURCHASE**



## **DISCOUNTED TOLEDO ZOO TICKETS**

2024 Ticket Prices

**\$26.00 for Adults (ages 12-59)**

**\$23.00 for Children (ages 2-11) & Seniors (60+)**

**\$11.00 for Parking**

[connect.toledozoo.org/consignment/rudolphlibbegroup](https://connect.toledozoo.org/consignment/rudolphlibbegroup)



# GREAT WORK REQUIRES GREAT PEOPLE

Thank you for providing a candidate referral in the month of **April!**

**Kevin Mankowski**

**Michael Glaze**

**Terrence Miller**

**Kodi Albright**

**Elizabeth Howard**

**Tim Roe**

**Mike Cuddeback**

**Mike Heskett**

**Tim Greenlese**

**Nate Fugett**

These associates have been entered into a quarterly drawing for a \$100 Amazon gift card!

**Know someone who would be a great addition to RLG?  
Contact Sara Caris at [Sara.Caris@rlgbuilds.com](mailto:Sara.Caris@rlgbuilds.com)**

## Get social with RLG! Follow us on social media!

X (formerly Twitter): @rlgbuilds

LinkedIn: Rudolph Libbe Group

Instagram: @rudolphlibbegroup

Facebook: Rudolph Libbe Group

(public page)

Rudolph Libbe Group Associates

(associates only)

YouTube: Rudolph Libbe Group



Send photos and ideas to:

[Tammela.Strait@rlgbuilds.com](mailto:Tammela.Strait@rlgbuilds.com)

[Vince.Piscopo@rlgbuilds.com](mailto:Vince.Piscopo@rlgbuilds.com)

[Staci.Ozuk@rlgbuilds.com](mailto:Staci.Ozuk@rlgbuilds.com)

# NOW HIRING

 NORTH RIDGEVILLE



**Project Manager**

**Project Engineer**

ONE GROUP  
OF COMPANIES,  
UNLIMITED  
**CAREER**  
OPPORTUNITIES

[RLGbuilds.com/Careers](https://www.rlgbuilds.com/Careers)

## News wanted!

Know a good story about RLG associates, excellent work at our jobsites, safety or our work in the community? Have some great photos?

Contact:

Vince Piscopo

ext. 3119/(419) 481-5094

[Vince.Piscopo@rlgbuilds.com](mailto:Vince.Piscopo@rlgbuilds.com)



## Promotion: Congratulations Chris Lee!



**Chris Lee**

Preconstruction Leader

RLI Walbridge

## New Work: First Solar/Burkes



GEM's Virtual Design and Construction team will provide Building Information Modeling services to Burkes Mechanical, a subcontractor on Rudolph Libbe's First Solar project in Louisiana

Burkes Mechanical is fabricating and installing the First Solar NAT-01 process pipe racks.

GEM VDC will also provide BIM services for the facility's Central Utility Building. All GEM VDC work will be performed in Walbridge.

The team: VDC Project Manager **John Marshall**; Lead VDC **AJ King**; VDC Tech **Eric Rife**.

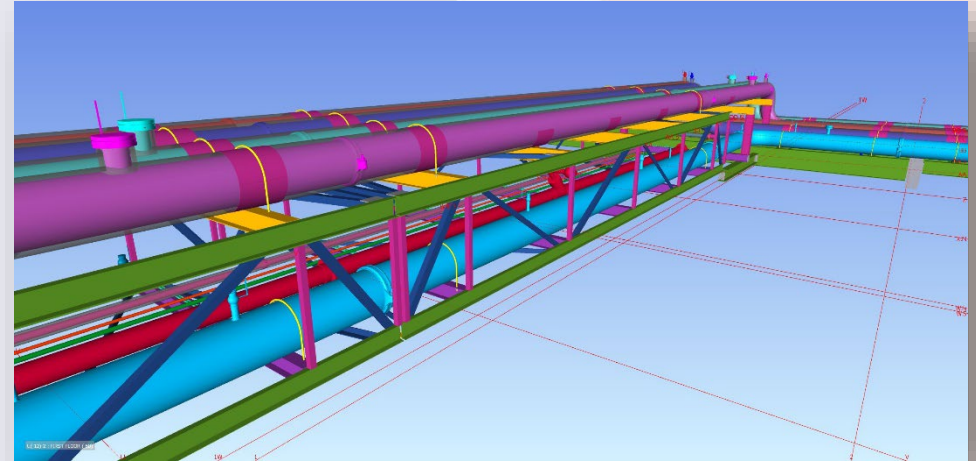



# NOW HIRING CO-OPS

ALL LOCATIONS



FALL 2024 & SPRING 2025

Civil Engineering

Construction Management

Mechanical Engineering

Electrical Engineering

ONE GROUP  
OF COMPANIES,  
UNLIMITED  
CAREER  
OPPORTUNITIES

[RLGbuilds.com/Careers](https://www.rlgbuilds.com/Careers)