

COMMONGROUND

MARCH 2018



The RLG team took on the historical preservation and extensive renovations of the Steam Plant and the construction of a three-story, glassed-in addition facing the riverfront.

PROMEDICA HEADQUARTERS WINS ASSOCIATED GENERAL CONTRACTORS' BUILD AMERICA AWARD

Congratulations to the entire project team on your second national award!

RLG has been honored with a Construction Risk Partners Build America Award presented by the Associated General Contractors of America. This award recognized the ProMedica project as one of the best construction projects of 2017 and the best building renovation project valued between \$10 million and \$99 million.

"These awards epitomize the latest and greatest projects the construction industry has to offer," said Art Daniel, the association's president and president of AR Daniel Construction Services in Cedar Hill, Texas. "The construction firms recognized have utilized outstanding skill, collaboration and innovation to complete some of America's most complex and ambitious projects of 2017."

RLI served as construction manager and GEM performed structural steel work for the Steam Plant and the Junction Building. The project involved extensive renovations

of the 78,465-square-foot Steam Plant and the 102,101-square-foot five-story Junction Building.

"The Build America Awards recipients represent the perfect integration of creative design, construction mastery and flawless execution which is inspiring to us all," said Rob Rapp of Construction Risk Partners.

The Construction Risk Partners Build America Awards highlight the nation's most significant construction projects. A panel of judges, representing all areas of construction, evaluated submissions for complexity, use of innovative construction techniques and client satisfaction, as well as other criteria.

The ProMedica HQ also recently received the Presidential Award of Excellence in Engineering from the American Institute of Steel Construction (AISC). This award is the highest honor presented by the U.S. structural steel industry.

RLG PEOPLE Welcome!



Tom Ulmer
VP of Sales,
GEM Energy

John Johnstone
Structural Project
Manager,
GEM Walbridge



Ramy Sarsour
Business
Development,
GEM Facility
Management

Jamie Generous
Account Manager,
RLG Michigan



Kira Marlatt-Spencer
Programmer/
Database
Administrator
RLG Walbridge

RUDOLPH LIBBE INC
GEM INC
GEM ENERGY
LEHMAN DAMAN
RUDOLPH LIBBE PROPERTIES



ASSOCIATES ON THE MOVE

Congratulations on your new assignments!



Tom LaFountain
Manager, Electrical,
GEM Walbridge
Previously: General
Manager, RLG Lima

Rick Wallace
General Manager,
RLG Lima
Previously:
Boilermaker Project
Manager



Jim Bronson
Structural Project
Manager,
GEM Walbridge
Previously: Millwright
Foreman

GET SOCIAL WITH RLG

Follow us on social media!

Twitter: @rlgbuilds
LinkedIn: Rudolph Libbe Group
Instagram: @rudolphlibbegroup
Facebook: Ask to join Rudolph Libbe
Group Associates
YouTube: Rudolph Libbe Group

STAY ALERT FOR LEADS KEEP US IN-THE-KNOW!

Each associate who reports a lead is entered into a drawing for \$100 in GEM and RLI merchandise. Thanks for the leads:

Toni Hubbard
Ray Craft
Brad Wilson

Denise Cromwell
Bob Briggs
Holly Rodenberger

Report your leads to:
Christie Fair, RLI, ext. 3246
Christie.Fair@rlgbuilds.com

Elizabeth Hancock, GEM, ext. 2603
Elizabeth.Hancock@rlgbuilds.com

COMPLETED PROJECT: HART, INC.

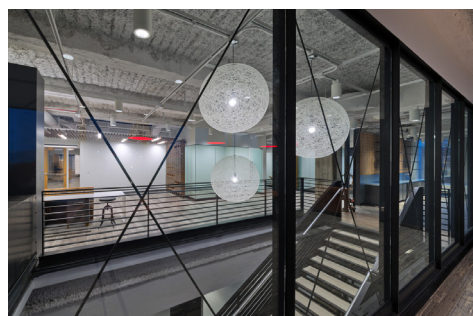

A private staircase connects
the 5th and 6th floors.

Toledo - Work is complete on the 20,000-square-foot renovation for Hart, Inc. in the Hylant Building. RLI served as the construction manager and general contractor and GEM performed mechanical, electrical, plumbing and structural steel.



Eastern Engineering's new demonstration room shows off CAD and printing capabilities.

KUDOS FROM EASTERN ENGINEERING

Northwood - After acquiring Toledo Blueprint, Eastern Engineering relied on RLI Special Accounts to renovate and expand its Toledo area demonstration room during the rebranding process. The main goal was to create a larger, more modern space to better serve customers.

During this design/build project, RLI combined two suites into one, installed flooring and painted the new demonstration room. An electrical rework was necessary to accommodate additional lighting and to power equipment on display. Work was completed at the end of December 2017.

Mark Langdon, president of Eastern Engineering, said, "RLI's craftsmanship was above and beyond expectations. RLI handled all aspects of the project, allowing myself and my management team to focus on day-to-day business. I can't stress enough how important that is."

WELCOME! SPRING 2018 CO-OPS



Gabrielle Myatt
University of Akron
Project Management
RLG Cleveland

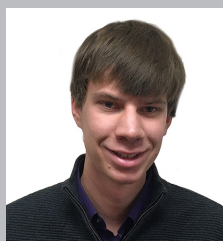

Eric Slink
University of Toledo
Special Accounts
RLI Walbridge



Landon Richards
Bowling Green State University
Special Accounts
RLI Walbridge



Justin Bourque
University of Toledo
Mechanical
GEM Walbridge